

Unidirectional Valves or Non Return Valves

- FEMALE-FEMALE NON RETURN VALVE

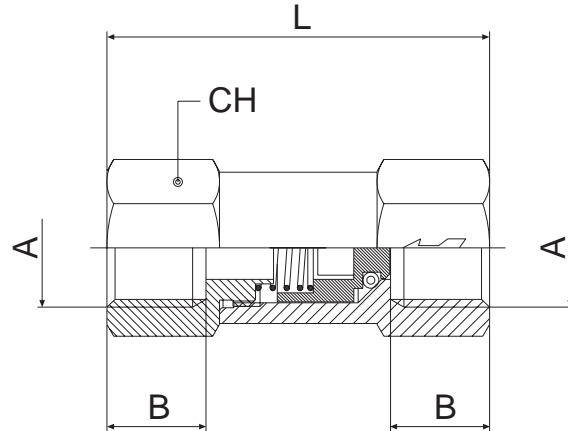
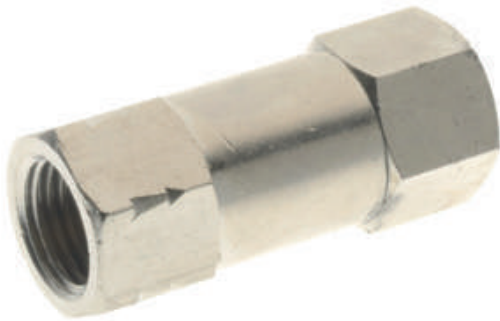

22.100

A	B	L	CH	Conf. Pack.
M5	5.5	26.5	8	10
1/8	8.5	35.5	13	10
1/4	11	43	17	10
3/8	12	58	24	10
1/2	15	63	24	10

Pressures

/ Minimum pressure: **2 bar** (0.2 MPa)
/ Maximum pressure: **8 bar** (0.8 MPa)

Approximate opening pressure: 0.2 bar (0.02 MPa)

Threads

/ Parallel gas in conformity with ISO 228.

Connection Tubes

Various types of fittings used on the pneumatic systems and metallic threaded tubes.

Component Parts and Materials

- 1 Nickel-plated Brass Body
- 2 Nickel-plated Brass Valve Back Part
- 3 NBR 70 O-RING Seals
- 4 Nickel-plated Brass Shutter
- 5 Steel AISI 302 Keep spring
- 6 NBR 70 O-RING Seals

Temperature / Temperatures

Temperatura minima / Minimum temperature: -20 °C
Temperatura massima / Maximum temperature: +80 °C

Fluids

/ Compressed air.

ATTENTION!

THE FREE EXHAUST TO ATMOSPHERE DO NOT ALLOW TO USE THE VALVE WITH TOXICS, CORROSIVES AND INFLAMMABLES GAS.